



25 Powerscourt Road

, Portsmouth, PO2 7JE

Guide price £260,000

Large Family Home | Large Upstairs Bathroom | Perfect for Modernising | Character Filled Property | Central Location | Close to Local Amenities | Close to Transport Links | Perfect for Families | Ideal for Investors | Planning for HMO Approved

- Large Family Home
- Large Upstairs Bathroom
- Perfect for Modernising
- Character Filled Property
- Central Location
- Close to Local Amenities
- Close to Transport Links
- Perfect for Families
- Ideal for Investors
- Planning for HMO Approved

Viewing

Please contact our ROK Marsh Office on 02393233267 if you wish to arrange a viewing appointment for this property or require further information.



3



1



2



D

Floor Plan

Area Map

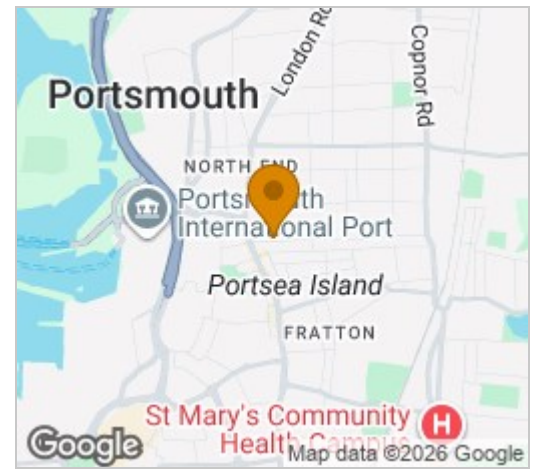
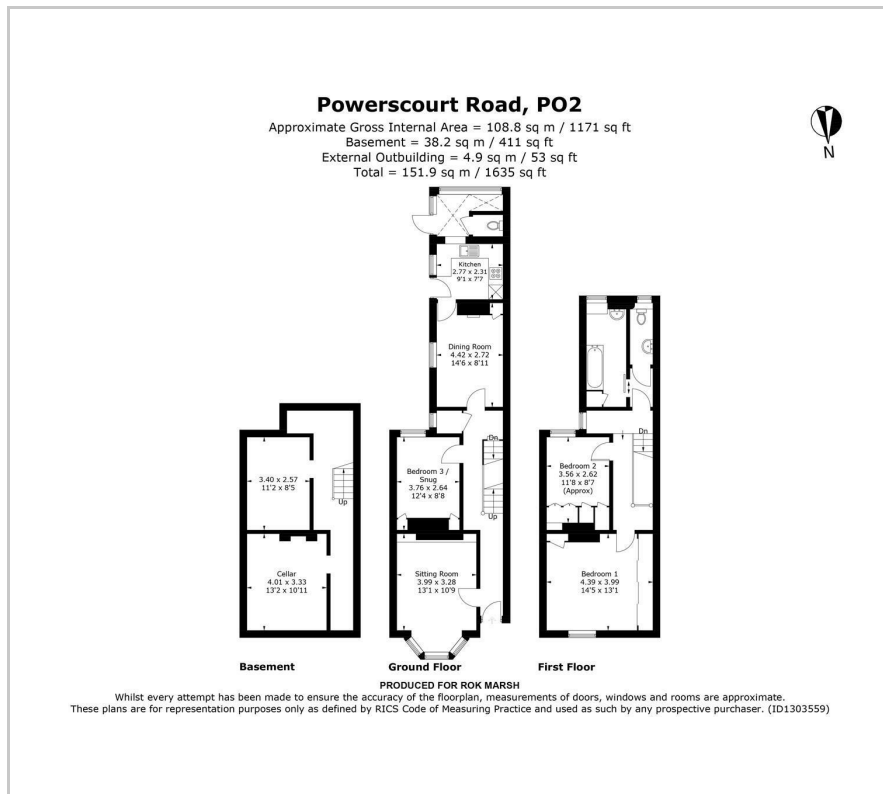

Energy Efficiency Graph

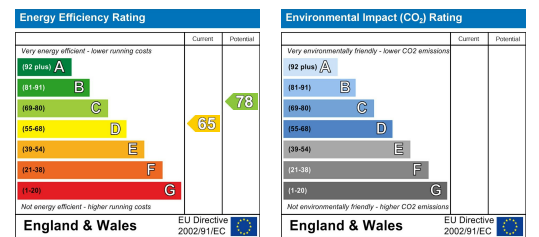

These particulars, whilst believed to be accurate are set out as a general outline only for guidance and do not constitute any part of an offer or contract. Intending purchasers should not rely on them as statements of representation of fact, but must satisfy themselves by inspection or otherwise as to their accuracy. No person in this firm's employment has the authority to make or give any representation or warranty in respect of the property.